

# Cochlear™ Wireless Mini Microphone

## Quick Guide for CP900 Series users



### Features of your Mini Microphone

Hear better over a distance and in noisy listening situations, such as:

- in meetings
- when travelling by car, bus or train
- dining at a restaurant
- participating in a class at the gym

#### How to:

Give the Mini Microphone to the person you want to listen to and ask them to position it close to their mouth by placing it on their clothing using the clip on the back. Then activate streaming on your CP900 Series Sound Processor (see instructions below).

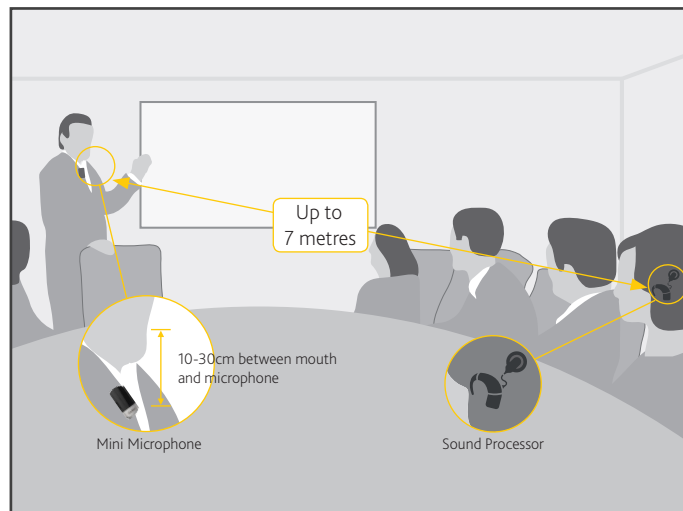

### Hear the TV or radio when you are away from home

#### How to:

If you are away from home, you can place the Mini Microphone by the TV speaker or radio. No need to plug it into a Head Phone outlet.



### Stream music or audio directly to your Sound Processor

#### How to:

Insert one end of the supplied jack cable into the Mini Microphone's Line-in socket and the other end into the audio out of your audio device, such as a computer, MP3 player or hi-fi.



### Product overview

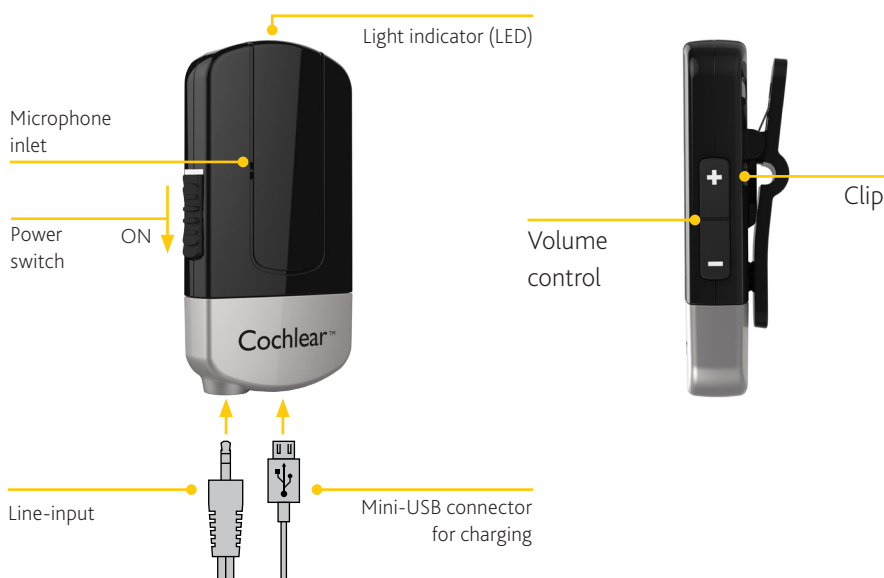

### Getting Started

#### Charging the battery

Plug one end of the included mini-USB charging cable into the Mini Microphone and the other into a computer, or into a power outlet via the supplied adapter.

Before you use your Mini Microphone you should allow it to charge for at least 3 hours, even if the indicator light shows a full charge. The battery cannot be overcharged.

**Note:** On average, the Mini Microphone will operate for up to 8.5 hours between charges.

## Pairing with your CP900 Series Sound Processor

- A** Switch off your CP900 Series Sound Processor.

Remove the Sound Processor from your ear.  
Press and hold the lower button for two seconds.



- B** Switch on your Mini Microphone and remove the silver cap.



- C** Press the pairing button on the Mini Microphone once using the tip of a pen or similar object.

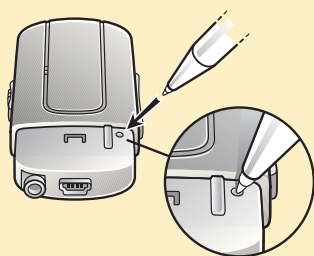

- D** The LED will flash yellow every 2 seconds and the Mini Microphone will now be in pairing mode for 20 seconds.



- E** While pairing mode is active (20 seconds), switch on your Sound Processor.

Press the lower button.

A blue indicator light flashes to show that pairing has been successful.



- F** You can pair up to three Cochlear wireless accessories with your Sound Processor(s).

To pair a Mini Microphone in channel 2 press the pairing button twice in step **C**. The LED will flash yellow twice every 2 seconds.

To pair a Mini Microphone in channel 3 press the pairing button 3 times in step **C**. The LED will flash yellow 3 times every 2 seconds.

## Support

For full details about the Mini Microphone, please refer to the User Guide that was packaged with your Mini Microphone, and the Wireless Accessories User Guide.

For full details about your Cochlear CP900 Series Sound Processor, please refer to its User Guide.

For further support and videos, visit the Cochlear website: [www.cochlear.com](http://www.cochlear.com)

## Using your Mini Microphone

### Start streaming using your sound processor

**A** Turn on your sound processor and Mini Microphone.



Long-press the upper button on your sound processor once.  
The sound processor flashes a blue light to indicate audio is streaming.

**B** To select another channel or stop streaming.



Long press the upper button a second time to select Channel 2, and again for Channel 3.

To stop streaming, short-press the upper button.

### Start streaming using your CR230 Remote Assistant

**Method 1:** Turn on your sound processor and Mini Microphone. Turn on your CR230 Remote Assistant.



Long-press the Telecoil button.

*Tip! Long press the button a second time to select Channel 2, and again for Channel 3.*

Audio will start streaming through the Mini Microphone.

To stop streaming, short-press the Telecoil button.

OR

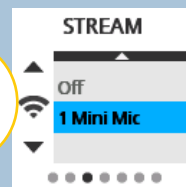

From the Home screen, press the right arrow button until you see the Stream screen.

Scroll down the list to the channel you want to use and press **OK**.

When your audio device is turned on, audio will start streaming through the Mini Microphone.

To stop streaming, select **Off** on the Stream selection screen.

### Start streaming using your CR210 Remote Control

**A** Turn on your sound processor and Mini Microphone. Turn on your CR210 Remote Control.

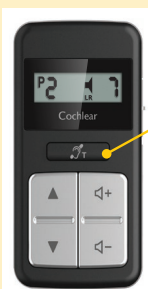

Long-press the Telecoil button.

Audio will start streaming through the Mini Microphone.

**B** To select another channel or stop streaming.

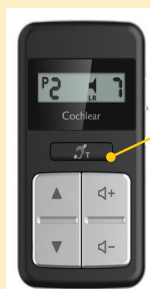

Long press the Telecoil button a second time to select Channel 2, and again for Channel 3.

To stop streaming, short-press the Telecoil button.

#### Cochlear Wireless Accessories:

**Cochlear Bone Anchored Solutions AB** Konstruktionsvägen 14, SE - 435 33 Mölnlycke, Sweden

Tel: +46 31 335 1461 Fax: +46 31 335 1460

Nucleus 6 System:

**Cochlear Ltd** (ABN 96 002 618 073) 1 University Avenue, Macquarie University, NSW 2109, Australia

Tel: +61 2 9428 6555 Fax: +61 2 9428 6352

**Cochlear Ltd** (ABN 96 002 618 073) 14 Mars Road, Lane Cove, NSW 2066, Australia

Tel: +61 2 9428 6555 Fax: +61 2 9428 6352

Regional Offices:

**Cochlear Americas** 13059 E Peakview Avenue, Centennial, CO 80111, USA

Tel: +1 303 790 9010 Fax: +1 303 792 9025

**Cochlear Deutschland GmbH & Co. KG** Karl-Wiechert-Allee 76A, 30625 Hannover, Germany

Tel: +49 511 542 770 Fax: +49 511 542 7770

株式会社日本コクレア (**Nihon Cochlear Co Ltd**) 〒113-0033 東京都文京区本郷2-3-7 お茶の水元町ビル

Tel: +81 3 3817 0241 Fax: +81 3 3817 0245

[www.cochlear.com](http://www.cochlear.com)

ACE, Advance Off-Stylet, AOS, AutoNRT, Autosensitivity, Beam, Button, Carina, Clininet, Cochlear, コクレア, Codacs, Contour, Contour Advance, Custom Sound, ESprit, Freedom, Hear now. And always, Hybrid, inHear, Invisible Hearing, MET, MP3000, myCochlear, NRT, Nucleus, Nucleus in Chinese characters, Off-Stylet, SmartSound, Softip, SPrint, the elliptical logo and Whisper are either trademarks or registered trademarks of Cochlear Limited. Ardium, Baha, Baha Divino, Baha Intenso, Baha PureSound, Baha SoftWear, DermaLock, Vistafix and WindShield are either trademarks or registered trademarks of Cochlear Bone Anchored Solutions AB. Bluetooth is a registered trademark of Bluetooth SIG.

© Cochlear Limited 2015