

Cochlear™ Wireless Mini Microphone

Quick guide for Baha® users



Benefits of your Cochlear Wireless Mini Microphone

Hear better over a distance and in noisy listening situations, such as:

- in meetings
- when travelling by car, bus or train
- dining at a restaurant
- participating in a class at the gym

How to:

Give the Mini Microphone to the person you want to listen to and ask them to position it close to their mouth by placing it on their clothing using the clip on the back. Then activate streaming on your Baha 4 Sound Processor (see instructions below).

Tip! You can attach the Mini Microphone to your own shirt when having a conversation with a smaller group.

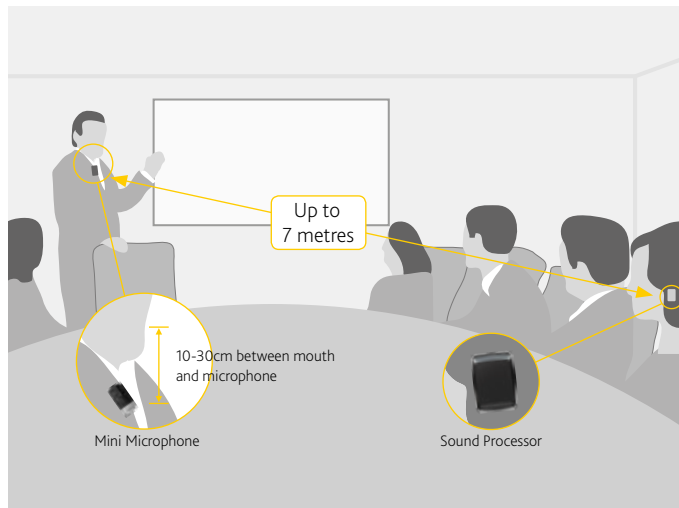

Hear the TV or radio better

How to:

Place the Mini Microphone by the TV speaker or radio. No need to plug it into a Head Phone outlet.



Stream audio to your sound processor

How to:

Insert one end of the supplied jack cable into the Mini Microphone's Line-in socket and the other end into the audio out of your audio device, such as a computer, MP3 player or hi-fi.



Product overview

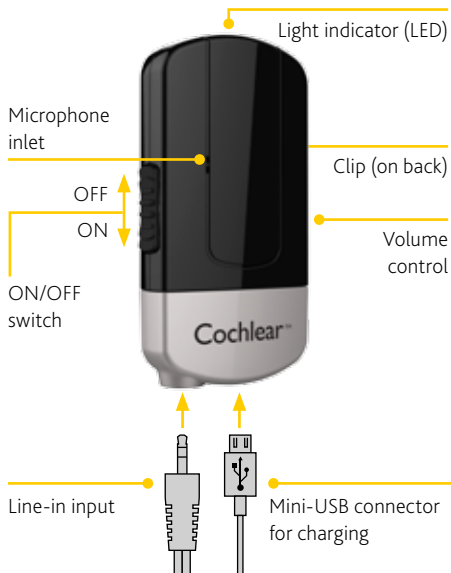

Getting Started

Check with your hearing healthcare professional whether your sound processor has been paired with your Mini Microphone. Pre-paired sound processors do not need to be paired again.

If your sound processor is not pre-paired, instructions on how to easily pair it with your Mini Microphone are on the last page of this guide.

Tip! Make sure that your sound processor volume is comfortably adjusted before you change the settings with the volume control on the Mini Microphone.

Charging the battery

Plug one end of the included mini-USB charging cable into the Mini Microphone and the other into a computer, or into a power outlet via the supplied adapter.

The first time you charge your Mini Microphone allow it to charge for at least 3 hours, even if the indicator light shows a full charge. The battery cannot be overcharged.

Note: The Mini Microphone will operate for up to 8.5 hours between charges.

Cochlear™ Wireless Mini Microphone

Quick guide for Baha® users



Using your Cochlear Wireless Mini Microphone

Changing settings via your sound processor

Changing settings with an optional remote control

Listening to sound from the Mini Microphone

Make sure both your sound processor and Mini Microphone are switched on, then:



Press and hold the middle button on your sound processor until an audio melody is heard.

OR



Press the streaming button and you will hear an audio melody.

Listening to sound from a second and/or third Cochlear Wireless Accessory

If your sound processor is paired with more than one wireless accessory, you can toggle between the accessories in the different channels, in one of two ways:



Press the middle button (long press) on your sound processor once, twice or three times, until you have selected the accessory you want.

OR



Press the streaming button once, twice or three times, until you have activated the accessory you want.

How to stop listening to a streaming accessory



Press the middle button (short press) on the sound processor to return to your previous program.

OR



Press the "Home" button to return to your default settings.

Press the "P" button to return to your previous setting.

Support

For full details about the Cochlear Wireless Mini Microphone, please refer to the User Manual.

For full details about the Cochlear Baha 4 Sound Processor, please refer to the User Manual part A.

For further support and videos, visit the Cochlear website: www.cochlear.com

Cochlear™ Wireless Mini Microphone

Quick guide for Baha® users



Pairing with your Baha 4 Sound Processor

A Switch off your Baha 4 Sound Processor:

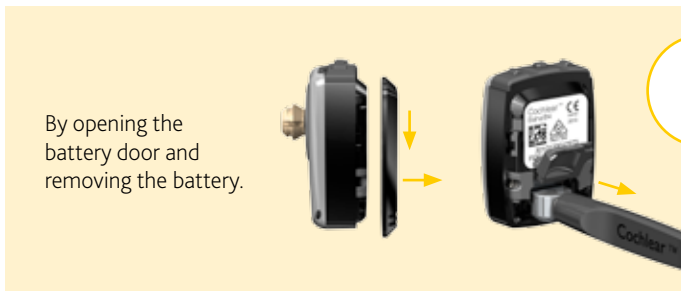

B Switch on your Mini Microphone and remove the silver cap.

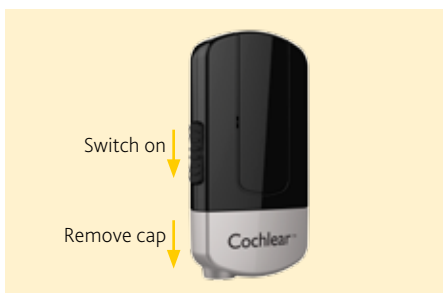

C Press the pairing button on the Mini Microphone once using the tip of a pen or similar object.

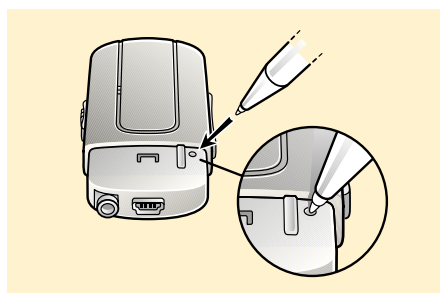

D The LED will flash yellow every 2 seconds and the Mini Microphone will now be in pairing mode for 20 seconds.



E While pairing mode is active, switch on your sound processor:



F Successful pairing will be indicated by an audible melody played in the sound processor.



G You can pair up to three Cochlear wireless accessories with your sound processor(s).
To pair a Mini Microphone in channel 2 press the pairing button twice in step **C**. The LED will flash yellow twice every 2 seconds.
To pair a Mini Microphone in channel 3 press the pairing button 3 times in step **C**. The LED will flash yellow 3 times every 2 seconds.

Manufacturer:
Cochlear Bone Anchored Solutions AB Konstruktionsvägen 14, SE - 435 33 Mölnlycke, Sweden
Tel: +46 31 792 44 00 Fax: +46 31 792 46 95

www.cochlear.com

Ardium, Baha, Baha Divino, Baha Intenso, Baha PureSound, Baha SoftWear, DermaLock, Vistafix and WindShield are either trademarks or registered trademarks of Cochlear Bone Anchored Solutions AB. Cochlear, Hear Now. And always and the elliptical logo are either trademarks or registered trademarks of Cochlear Limited. © Cochlear Bone Anchored Solutions AB 2014. All rights reserved. JAN14. E82990