

# Cochlear™ Wireless TV Streamer Quick Guide

## Benefits of your Cochlear Wireless TV Streamer

The Cochlear Wireless TV Streamer will provide you with high quality streamed audio from your TV, stereo, personal computer or similar device directly to your sound processors.

*Note: The TV Streamer can be paired with several Baha 4 sound processors for bilateral use, and to facilitate several users listening to the same streamer.*

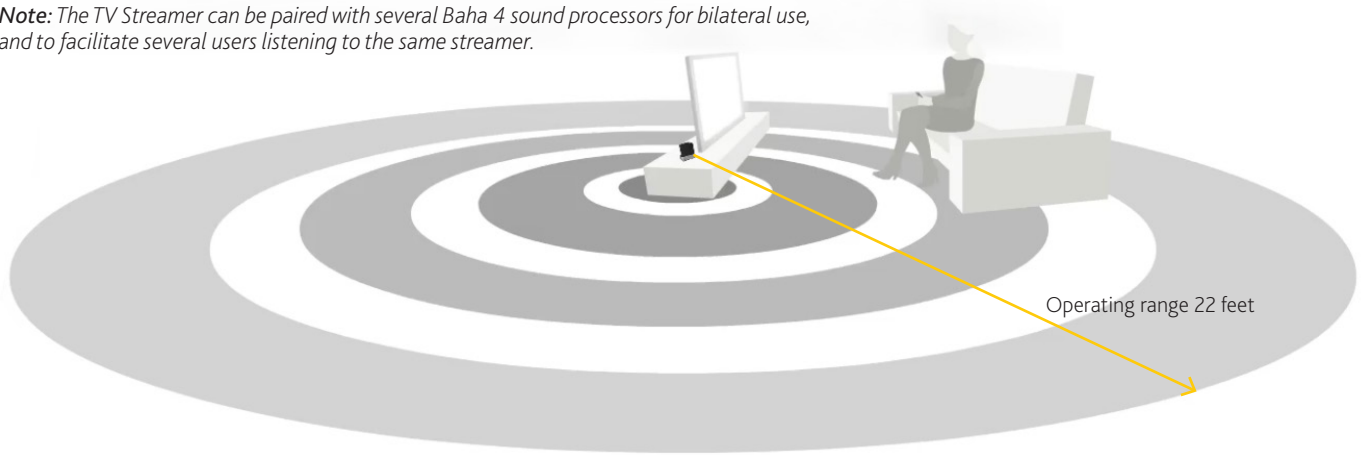

## Product overview

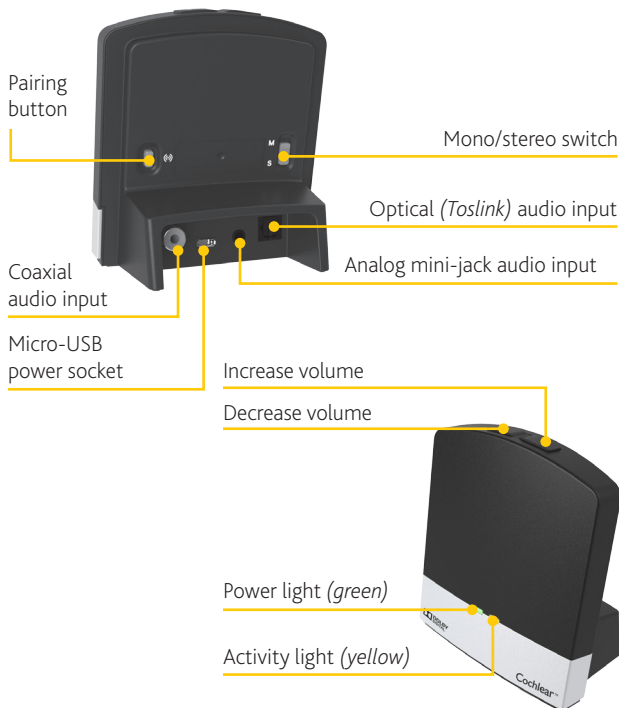

## Getting Started

The TV Streamer supports both analog and digital audio inputs. Depending on your TV, HiFi stereo, computer or other audio device, the TV Streamer can be installed in several ways, as described on the following pages.

For all installations, it is necessary to:

- A** Plug the power cord into the micro-USB socket on the TV Streamer.
- B** Plug the other end of the power cord into an electric wall socket. Connect the TV Streamer to your audio source using one of the following 5 installations.

## Support

For full details about the Cochlear Wireless TV Streamer, please refer to the User Manual.

For full details about the Cochlear Baha 4 Sound Processor, please refer to the User Manual part A.

For further support and videos, visit the Cochlear website: [www.Cochlear.com/US](http://www.Cochlear.com/US)

# Cochlear™ Wireless TV Streamer Quick Guide

## Using the Cochlear Wireless TV Streamer

### Connecting the TV Streamer to an analog audio source (e.g. TV or HiFi stereo).

- A** Plug the stereo mini-jack on the audio cable into the stereo mini-jack input on the TV Streamer.
- B** Plug the other end of the audio cord into the "AUDIO OUT" terminals on the audio source. "AUDIO OUT" is usually marked "L – R" for left and right, and is normally located on the back of the audio source.

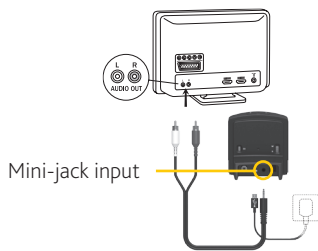

### Connecting the TV Streamer to an analog audio source using a headphone mini-jack adaptor.

- A** Plug the stereo mini-jack on the audio cable into the stereo mini-jack input on the TV Streamer.
- B** Connect the stereo mini-jack adaptor to the red and white plugs at the other end of the audio cable.
- C** Plug the stereo mini-jack adaptor into the audio source's "HEADPHONE" output terminal.

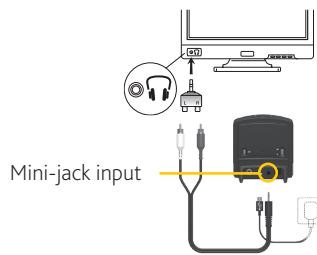

### Connecting the TV Streamer to an analog audio source using a scart adaptor.

- A** Plug the stereo mini-jack on the audio cable into the stereo mini-jack input on the TV Streamer.
- B** Connect the scart adaptor to the red and white plugs on the other end of the audio cable.
- C** Plug the scart adaptor into the audio source's scart terminal.

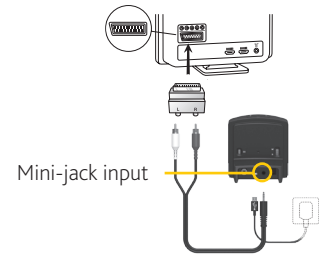

### Connecting the TV Streamer to a digital audio source using the optical (Toslink) audio input.

- A** Insert one of the plugs on the optical audio cable into the optical audio socket on the TV Streamer.

*Note: Most optical cables are delivered with a small protective cap to protect the tip of the plug. Please remove this protective cap before inserting the cable.*

- B** Plug the other end of the optical audio cable into the "Digital Audio Out/Optical" socket on your audio source.

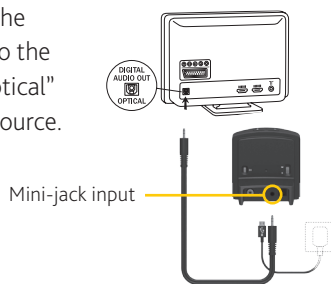

### Connecting the TV Streamer to a digital audio source using the coaxial audio input.

- A** Insert one of the plugs on the coaxial audio cable into the coaxial audio input socket on the TV Streamer.
- B** Plug the other end of the coaxial audio cable into the "Digital Audio Out/ Coaxial" socket on your audio source.

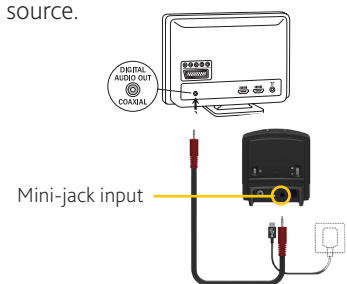

# Cochlear™ Wireless TV Streamer Quick Guide

## Using your Cochlear Wireless TV Streamer

### Activating streaming

#### Changing settings via your sound processor

After installation, you can listen to streamed audio from the TV Streamer by following these simple steps:

First, switch on your TV, sound system or computer and then, press and hold down the middle button on your sound processor(s) for 3 seconds. If necessary, this must be done separately for each processor in order to hear streamed audio in both ears.

OR

#### Changing settings via your Remote Control

If you are using a Cochlear Baha Remote Control (optional), simply press the streaming button.

When using the optional Remote Control, the display will indicate that it is searching before confirming it is connected to the TV Streamer.

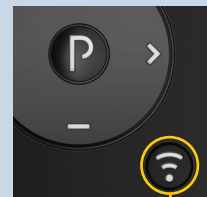

Streaming button

### To stop listening to streaming audio:

Briefly press and release the push button on your sound processor.

OR

Press the "P" button on the Remote Control.

### Pairing with your Baha sound processor

- A** Make sure the TV Streamer is plugged into a wall socket with the green power light on.

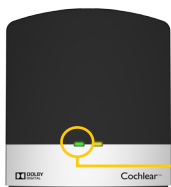

Green power light

- D** You can tell the pairing mode has been activated when the channel indicator is flashing. Pairing mode will be active for 20 seconds.

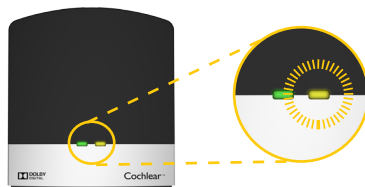

- B** Turn off your sound processor.
- C** Press the pairing button on the TV streamer once to activate its pairing mode.



Pairing button

- E** While the channel indicator light is flashing, turn on your sound processor.

*Note: Successful pairing will be indicated by an audible melody played in your sound processor(s).*

**You are now ready to use the TV Streamer!**

### Pairing several TV Streamers to one sound processor

It is possible to pair up to three TV Streamer units with your sound processor(s).

To pair a second or third TV Streamer, follow steps **A** and **B** left of this column.

- C** Then press the pairing button of the second TV Streamer two or three times.
- D** The yellow light indicator on the front of the TV Streamer will now blink two or three times every 2 seconds to indicate it is ready to be paired in Channel 2 or 3 of the sound processor.

Pairing button pushes	LED blinking pattern				Channel
1	1	1	1	1	1
2	1 2	1 2	1 2	1 2	2
3	1 2 3	1 2 3	1 2 3	1 2 3	3

- E** Complete the pairing process by turning on the sound processor(s).

[www.Cochlear.com/US](http://www.Cochlear.com/US)

**Cochlear Americas**  
13059 East Peakview Avenue  
Centennial, CO 80111 USA  
Telephone: 1 303 790 9010  
Support: 1 800 483 3123

**Cochlear Canada Inc.**  
2500-120 Adelaide Street West  
Toronto, ON M5H 1T1 Canada  
Telephone: 1 416 972 5082  
Fax: 1 416 972 5083

BUN296 ISS1 AUG14

©Cochlear Limited 2014. All rights reserved. Hear now. And always and other trademarks and registered trademarks are the property of Cochlear Limited or Cochlear Bone Anchored Solutions AB. The names of actual companies and products mentioned herein may be the trademarks of their respective owners.



Hear now. And always

